

UTX Scissor Lift

- Approx 18' working height
- Two man capacity
- 500 lbs capacity
- Easily removed for storage
- Self powered with charger
- 60" x 30" or 60" x 44" working platform
- Quick and easy manual leveling
- Can be leveled to lift on uneven ground
- Can be fitted to most utility UTVs
- 4 standard jacks included

UTX Safety Features

- Visual & Audible Alarms & Lockout
- Outrigger Legs for Stability
- Non-slip Platform & Steps
- Overload Alarm & Lockout
- Tilt Alarm & Lockout
- Stability Alarm and Lockout
- Emergency Lowering Valve
- Emergency Stop
- Push to Enable Function

Easy On – Easy Off

Easy moving from one place to the next. Less than 3 minutes to remove and store the UTX. There are just 2 bolts!

UTX Options and Accessories:

- Electric Jacks
- Electric Jack Remote Control
- Power Driver Jacks
- Fenders
- Quick Lock System
- Utility Box

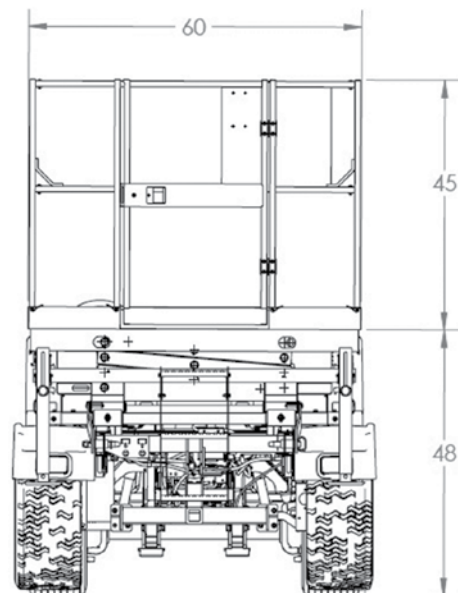

UTX

UTV REMOVABLE PLATFORM SCISSOR LIFT

Specifications

12 VDC System with Heavy Duty Group 31 Battery
On Board Battery Charger
Fork Lift Loadable
Wt. 825 lbs. (347.5 kilo) UTX30
Wt. 985 lbs. (448 kilo) UTX44

Operating Dimensions

Max. Work Height 18' (5.5m)
Max. Platform Height 12' (3.7m)
Safe Work Load 500 lbs. (226.8kg)

Platform Dimensions

Length 30" (76.2cm) UTX30
Length 44" (112cm) UTX44
Width 60" (152.4cm) BOTH
Guard Rail Ht. 45" (114cm) BOTH
Toe Board 4" (10cm) BOTH



TMX

TOWABLE
DRIVABLE
MINI
EXCAVATOR

TPX

TOWABLE
DRIVEABLE
PLATFORM
SCISSOR LIFT

UTX

UTV
REMOVABLE
PLATFORM
SCISSOR LIFT



8404 Venture Circle, Weston, WI 54476
T/F 888.359.3002 • www.iequipt.com



TPX Safety Features

- Visual & Audible Alarms
- Outrigger Legs for Stability
- Non-slip Platform & Steps
- Overload Alarm
- Tilt Alarm
- Emergency Lowering Valve
- Emergency Stop
- Push to Enable Function

Quick & Easy Auto-Level

One touch button setup, in just seconds on most terrains.

TPX Options & Accessories

- Tool Tray • Spare Tire
- Stadium Lights



SELF DRIVEN with platform controls

DRIVE in all weather conditions

ZERO turning radius

TRAVEL SPEEDS up to 3mph (5kpm) on multiple surfaces

AC POWER to platform is standard

FOLDING RAILING SYSTEM is standard

TPX

TOWABLE DRIVABLE PLATFORM SCISSOR LIFT

Specifications

28' (884cm) Working Height

24 VDC System with 4 Heavy Duty Group 31 Batteries

On Board Battery Charger

Fork Lift Loadable

Towable at Highway Speeds

No Trailer Required

Weight – 3250 lbs. (1474.2 kilo)

Operating Dimensions

Max. Work Height 28' (884cm)

Max. Platform Ht. (A) 22' (700cm)

Safe Work Load 750 lbs. (340kg)

Platform Dimensions

Length 64" (1.62m)

Width 48" (1.22m)

Guard Rail Height (B) 48" (122cm)

Extension Roll Out (C) 32" (81.28cm)

Toe Board 6" (15.24cm)

Machine Dimensions

Stowed Height (D) 95" (241cm)

Platform Length Extended 96" (243cm)

Outrigger Foot Print Deployed (E) 81" x 77" (205x195cm)

Overall Length (F) 147" (373cm)

Width Outriggers Retracted (G) 64" (162cm)

Ground Clearance 10.5" (26.67cm)

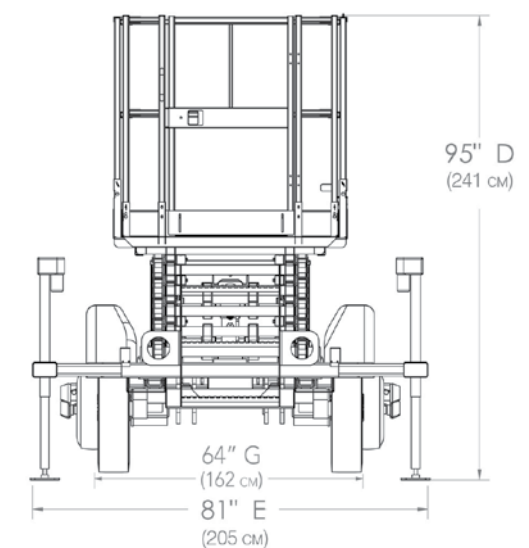
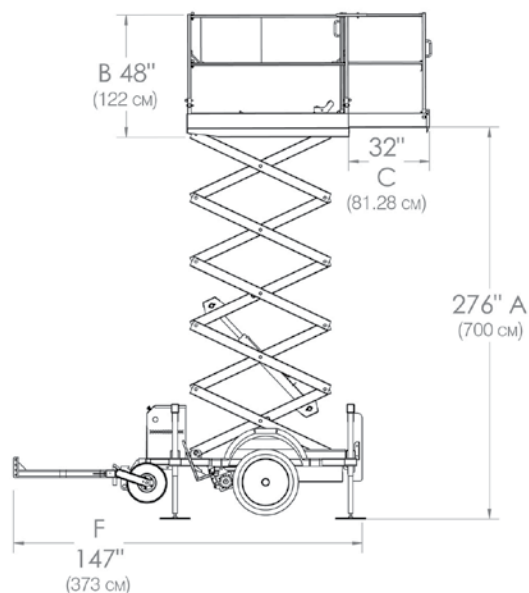

BIG POWER IN A COMPACT PACKAGE

The TMX® produces 3.3 tons (2.9 metric tons) of digging force, making it one of the most powerful excavators in the world for its size and weight.

NO TRAILER OR CDL REQUIRED

The TMX® is always ready to work with its own built-in trailer and lock-out drive hubs. You can tow it at highway speeds with most pickups, vans, and other light duty tow vehicles.

CRADLE OBJECTS BETWEEN THE BACKHOE AND THE BACKFILL BLADE

The TMX® is powerful, efficient, easy to operate, and versatile.

TMX® Latest Upgrades

- Electronic Control Circuits Reduce the Amount of Hydraulic Hose by 30%
- Switchable Travel Speed Control
- Multi-function Joysticks
- Steel Fuel and Oil Tanks
- Plastic (TPO) Parts are More Flexible, Oil and Gasoline Resistant



Quick-On, Quick-Off

Hitch system gets you to work faster and saves you energy.

Power Hundreds of Hydraulic Tools

No need to bring an air compressor or back-breaking jackhammers.

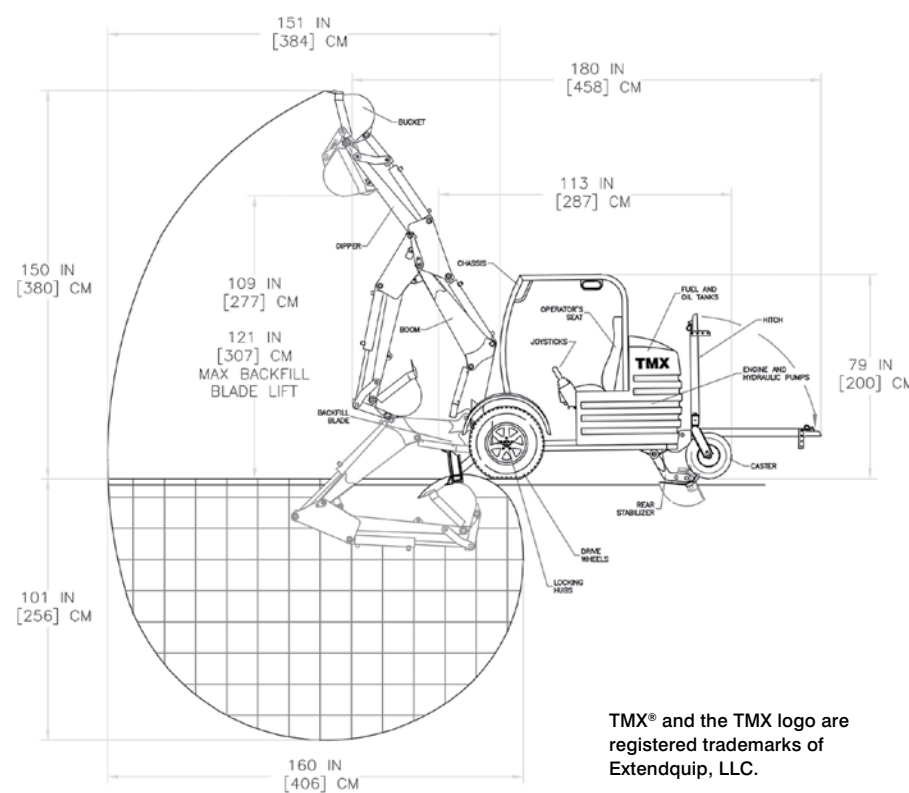

TMX® and the TMX logo are registered trademarks of Extendquip, LLC.

TMX

TOWABLE DRIVABLE MINI EXCAVATOR

Powered by Gas or Deisel Engine

Make: Honda, 3 Year Warranty

Horsepower: 21 hp (15.5 kW) @ 3600 rpm

Torque: 38.6 lbs- ft (48.3Nm) @ 2800 rpm

Dimensions

Length: 151 in. (384 cm)

Width: 74.5 in. (189.3 cm)

Height: 79 in. (201 cm)

Weight: 2,941 lbs. (1334 kg)

Tongue Weight: 380 lbs. (172 kg)

Hydraulic System

Hydraulic Pumps: 2

Type: Pump, electronic controlled, output flow (4.1 gpm ea@1800 rpm)

Displacement Dig Functions: 5.7 gpm @ 3600 rpm

Displacement Tool Circuit: 10 gpm@3600 rpm

Cooler: Air to Oil with Fan

Filtration: Suction & Return, 10 micron

System Relief Pressure: 2500 psi (17000kPa)

Hoses: Abrasion Resistant

Drive System

Pumps

Wheel Motors: High efficient orbital motor with disengaging hubs

Drive Tires: LT235/75R15 Mud-Terrain

Performance

Max Travel Speed: 3 Speed Key Switched 100% 6mph(10kpm), 75% 4.5mph(7kpm) and 50% 3mph(5kpm)

Turning Radius: Zero

Digging Depth: 8' (244 cm)

Loading Height: 7'2" (218 cm)

Digging Force

Bucket: 4050 lbs. (1835 kg)

Dipper: 2550 lbs. (1155 kg)

Swing System

Min. Swing Radius: 62 in. (157.5 cm)

Boom Swing: 140 degrees (70 right + 70 left)

Backfill Blade

Blade Width: 72 in. (183 cm)

Max Machine Lift: 9.5 in. (24.13 cm)

Blade Tilt: 21 degrees (10.5 right + 10.5 left)

Tool Circuit

Flow: 10 gpm (37 l/min) @ 3600 rpm

Pressure: 2000 psi (13750 kPa)

1/2" Flat Face - Quick Disconnect

Options:

Kubota Deisel 901 21.6 hp

Boom AUX Circuit

Thumb

Quick Attach Bucket